

DRY BATTERY

DRY | CONVENTIONAL

REF **HBB16A-AA**



12v VOLTAGE - V

210A CCA - A

16.8h CAPACITY - Ah (20Hr)

16Ah CAPACITY - Ah (10Hr)

TECHNOLOGY

- Lead acid dry charged construction (absorbed acid)
- No acid in cells, must be filled with acid before use
- 6 & 12V batteries

FEATURES

- Upright installation only
- Has to be checked periodically and refilled with water if necessary
- Internal gas emission through venting hole
- Handle with care to prevent acid spillage
- Regular life duration
- Does not need to be recharged while stocked

UPGRADE FOR

WEIGHT

Battery (with acid): Approx 5.06kg

MOUNTING ANGLE

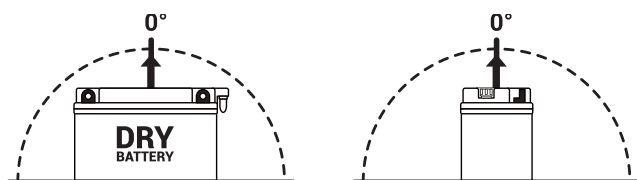

Upright installation only

DIMENSIONS

Length (A): 151mm ±2mm
Width (B): 91mm ±2mm
Container height: 180mm ±2mm
Total height (C): 180mm ±2mm

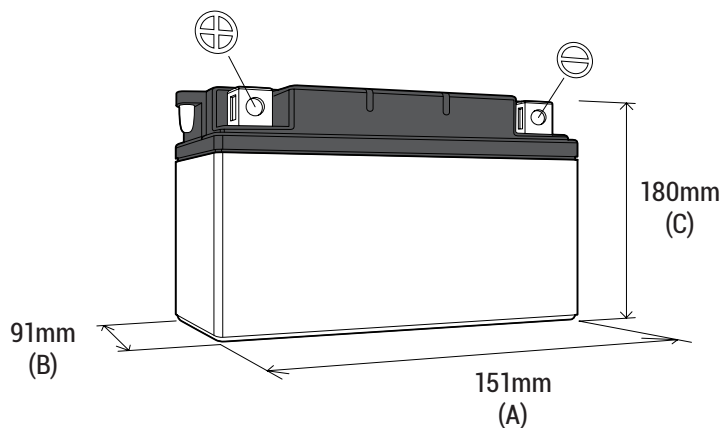

TERMINALS (mm)

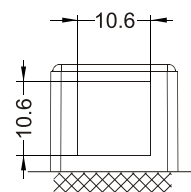

FRONT

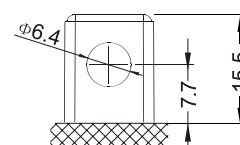

SIDE

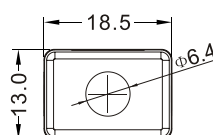

TOP