

**MF**  
BATTERY

MF | MAINTENANCE FREE

REF

**BT14B-BS**

12v

VOLTAGE - V

210A

CCA - A

12.6Ah

CAPACITY - Ah (20Hr)

12Ah

CAPACITY - Ah (10Hr)

## TECHNOLOGY

- AGM construction (absorbed acid)
- VRLA battery (Valve Regulated Lead Acid)
- Supplied with a separate acid pack
- Homologated by OEM

## FEATURES

- Upright installation only
- Maintenance free (no water refilling)
- Sealed after filling, no gas emission through venting hole (under normal operation)
- High power
- Does not need to be recharged while stocked
- Suitable for cold weather
- Reduction of plate sulfation
- Higher life cycle (up to three times longer than conventional batteries)
- Longer voltage hold

## UPGRADE FOR

## WEIGHT

Battery (with acid):

Approx 4.18kg

## MOUNTING ANGLE



Medium inclinaison

## DIMENSIONS

Length (A):	150mm ±2mm
Width (B):	70mm ±2mm
Container height:	145mm ±2mm
Total height (C):	145mm ±2mm

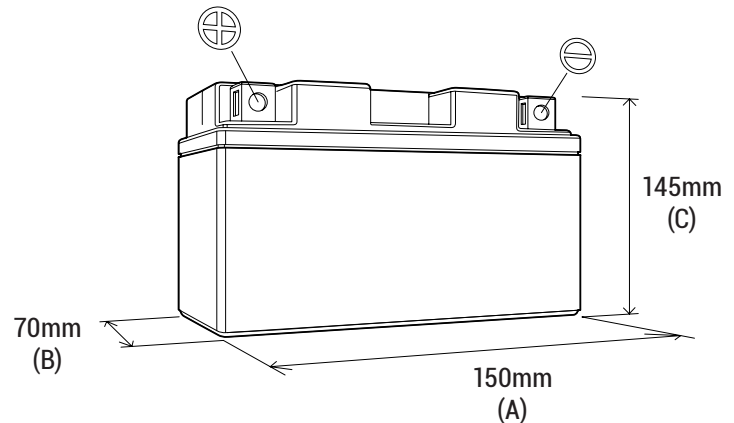

## TERMINALS (mm)

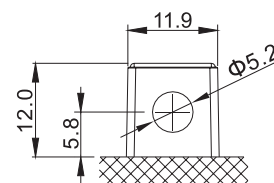

FRONT

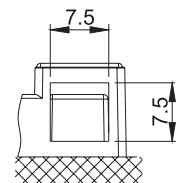

SIDE

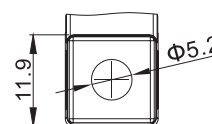

TOP