

BB12A-B

BS CODE: 310562

VOLTAGE **12V**

CCA **155A**

CAPACITY 20HR **12.6Ah**

CAPACITY 10HR **12.0Ah**



DIMENSIONS

LENGTH	134 ±2mm	5.28 ±0.08inch
WIDTH	81 ±2mm	3.19 ±0.08inch
TOTAL HEIGHT	160 ±2mm	6.3 ±0.08inch
WEIGHT	2.88 kg ±5%	6.35 lbs ±5%

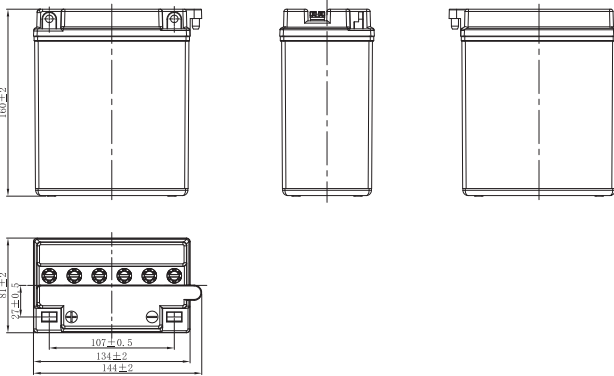

TERMINAL (mm)

POLARITY

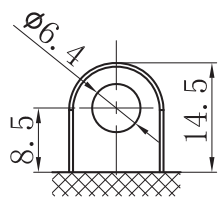

FRONT

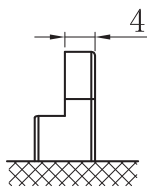



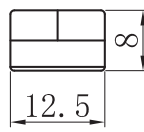



SIDE

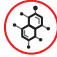

TOP

DRY FEATURES

-  **TO BE ACTIVATED**
DRY-charged technology.
-  **ACID PACK INCLUDED**
For initial filling.
-  **PERIODIC MAINTENANCE**
Refilled with water if necessary.
-  **HANDLE WITH CARE TO PREVENT ACID SPILLAGE**
-  **LONG SHELF LIFE**
No need to be recharged while stocked (if not activated).
-  **INTERNAL GAS EMISSION THROUGH VENTING HOLE**
-  **WIDE VARIETY OF 6V & 12V MODELS**

MOUNTING ANGLE

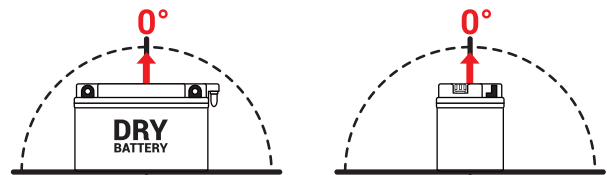

UPGRADE FOR

SLA MAX	SLA	MF	DRY
-	-	-	-