

BB18L-A

BS CODE: 310586

VOLTAGE **12V**

CCA **235A**

CAPACITY 20HR **18.9Ah**

CAPACITY 10HR **18.0Ah**



DIMENSIONS

LENGTH	180 ±2mm	7.09 ±0.08inch
WIDTH	90 ±2mm	3.54 ±0.08inch
TOTAL HEIGHT	162 ±2mm	6.38 ±0.08inch
WEIGHT	4.02 kg ±5%	8.86 lbs ±5%

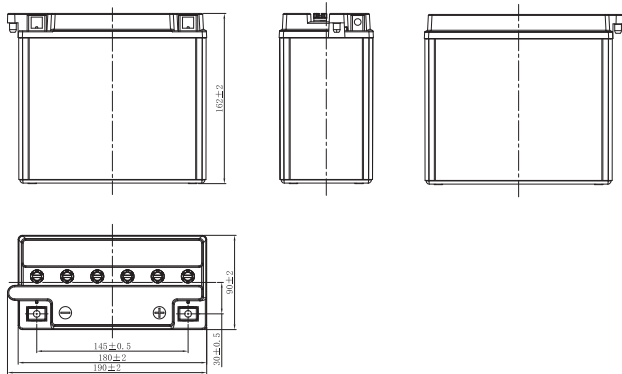

TERMINAL (mm)

POLARITY

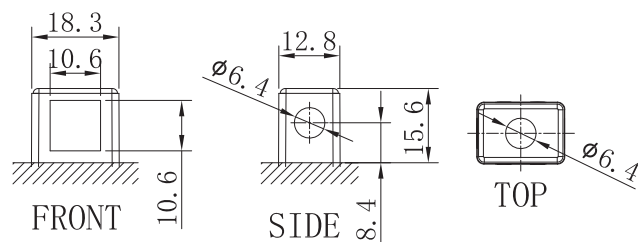

DRY FEATURES

- TO BE ACTIVATED**
DRY-charged technology.
- ACID PACK INCLUDED**
For initial filling.
- PERIODIC MAINTENANCE**
Refilled with water if necessary.
- HANDLE WITH CARE TO PREVENT ACID SPILLAGE**
- LONG SHELF LIFE**
No need to be recharged while stocked (if not activated).
- INTERNAL GAS EMISSION THROUGH VENTING HOLE**
- WIDE VARIETY OF 6V & 12V MODELS**

MOUNTING ANGLE



UPGRADE FOR

SLA MAX	SLA	MF	DRY
-	-	-	-